

DOUBLE JU INTERNATIONAL Ltd.

Distribution of BARTHOLOMY Reel Handling Units



BARTHOLOMY AL AUTO-LIFT / ALK AUTO-LIFT COMBINED



AL

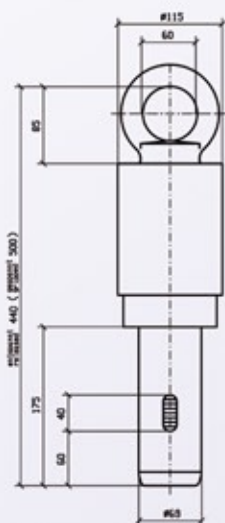

Dimension drawing AL 70/76

Product features:

- Simple and safe operation
- Sturdy
- Automatic gripping principle

Reel datas:

- Reel weight,
standard: 1.000, 2.000 kg
Gmax: 4.000 kg
- Gripper:
standard 70, 76,2 and
150, 152,4 mm
- Available gripper
for core sizes: 30 - 650 mm
- Other dimension on request



ALK

- Comined Auto-Lift
for different core sizes

A working operation is shown on the back

DOUBLE JU INTERNATIONAL Ltd.

Distribution of BARTHOLOMY Reel Handling Units



Working operation BARTHOLOMY AL AUTO-LIFT:



1. Lowering



2. Inserting



3. Set down,
at slack rope, automatic
switch to gripping



4. Lifting



5. Set down,
at slack rope
automatic switch to
releasing



6. Removal